

1609 - 1699 OLD U.S. HWY 70 W, CLAYTON, NC, 27520



UNIT #1649 | APPROX. 1,200 RSF

SUITE FEATURES

- \$16.00 PSF MG.
- \$3.00 PSF estimated TICAM.
- Semi-open plan layout.
- Private office
- Rear office/storage area.
- Private restroom.

PROPERTY FEATURES

- Front public parking & paved rear loading area.
- High-traffic signalized intersection with multiple complex entrances.
- Convenient location:
 - 2.1 miles from Downtown Clayton.
 - 8.9 miles from Downtown Garner.
 - 16.5 miles from Downtown Raleigh.

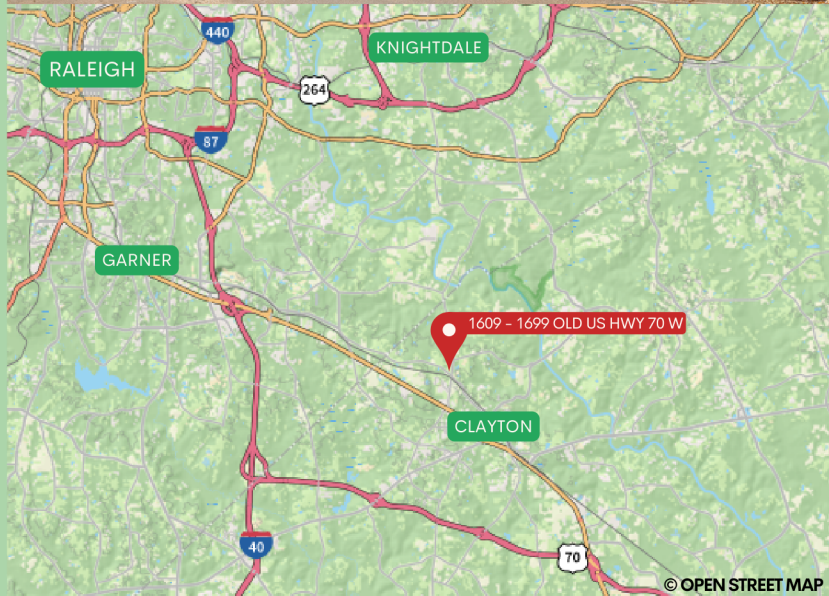

CONTACT US TODAY

CALL US AT
(919) 828-9999

VISIT US AT
HobbsProperties.com

BROKERAGE • LEASING
PROPERTY MANAGEMENT
CONSTRUCTION • DEVELOPMENT



FLOORPLANS

SUITE OUTLINE

NOTE: UNIT SHOWN ROTATED 90°

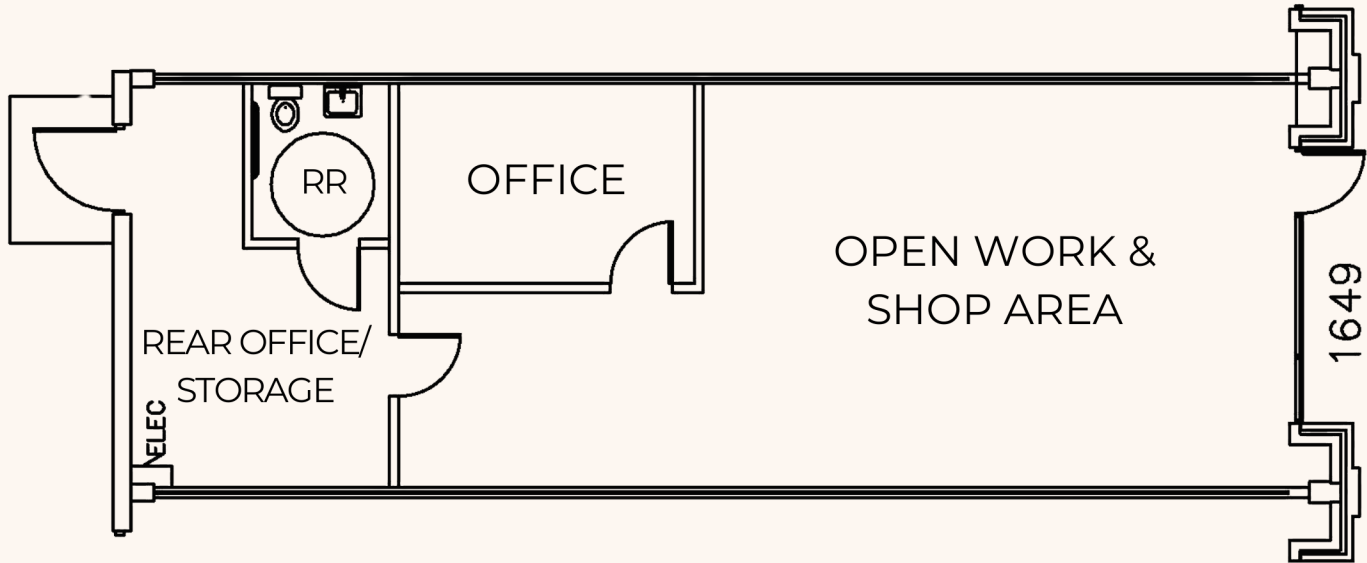

FLOOR PLATE

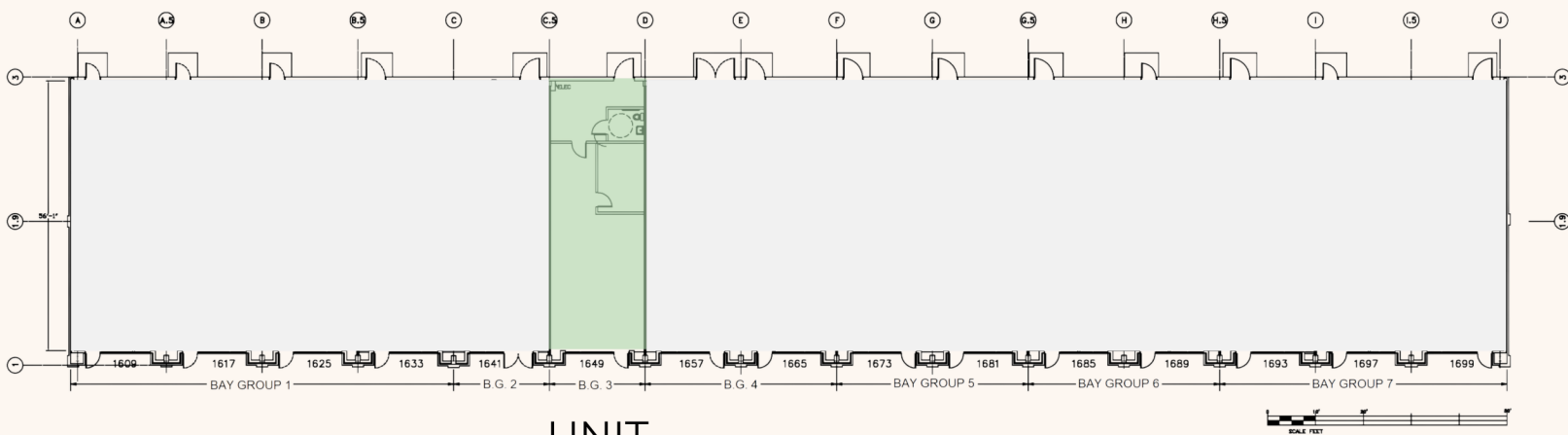

UNIT
1649

CONTACT US TODAY

CALL US AT
(919) 828-9999

VISIT US AT
HobbsProperties.com

BROKERAGE • LEASING
PROPERTY MANAGEMENT
CONSTRUCTION • DEVELOPMENT

