

WORLD TRADE PARK
10700 WORLD TRADE BLVD.
Raleigh, NC 27609



SUITE 114 | APPROX. 3,292 SF

SUITE FEATURES

- \$16.50/SF NNN
- \$2.14/SF estimated TICAM
- End cap suite.
- 18'+ clear height in warehouse area.
- Space features: two private restrooms, break room, conference room, four offices, two storage rooms, open work areas, & a warehouse area with roll-up door.
- Covered fees: sewer, septic & landscaping.

PROPERTY FEATURES

- Convenient drive-up flex/retail space in the RTP area.
- Expansive wrap-around parking lot with loading dock area, large enough for multiple semis.
- Full-panel glass storefront.
- Convenient location:
 - 2.0 miles from Brier Creek Commons shopping center (over 800K SF retail).
 - 1.2 miles from I-540 highway.
 - 3.5 miles from Raleigh-Durham international airport.
 - 10.5 miles from downtown Durham.

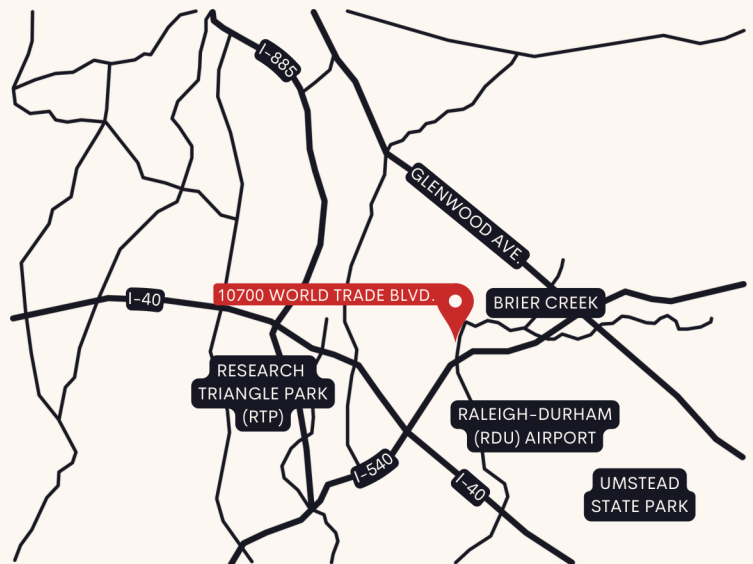

CONTACT US TODAY

CALL US AT
(919) 828-9999

VISIT US AT
HobbsProperties.com

BROKERAGE • LEASING
PROPERTY MANAGEMENT
CONSTRUCTION • DEVELOPMENT



SPACE LAYOUT

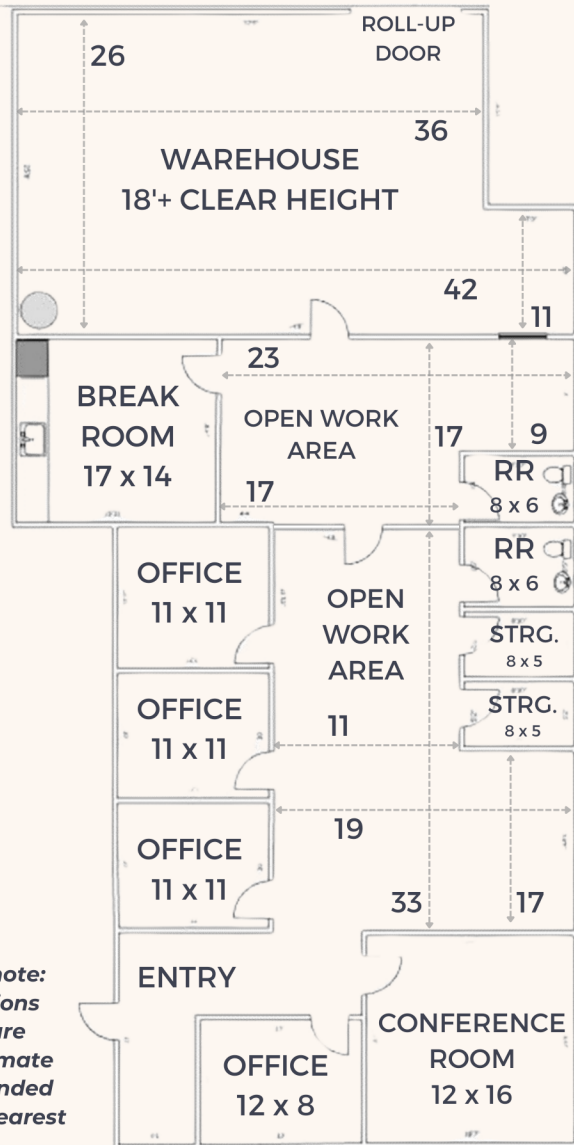

*Please note:
Dimensions
shown are
approximate
and rounded
to the nearest
foot.*

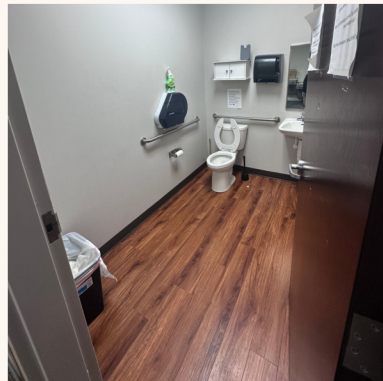

CONTACT US TODAY

CALL US AT
(919) 828-9999

VISIT US AT
HobbsProperties.com

BROKERAGE • LEASING
PROPERTY MANAGEMENT
CONSTRUCTION • DEVELOPMENT



AERIAL VIEW



CONTACT US TODAY

CALL US AT
(919) 828-9999

VISIT US AT
HobbsProperties.com

BROKERAGE • LEASING
PROPERTY MANAGEMENT
CONSTRUCTION • DEVELOPMENT

